

# MASS TIMBER BOOTH CATALOG



**FOUST**  
★ FAB & ERECTORS ★

2026

---

# MASS TIMBER MOCKUP

Our Mass Timber Mockups are designed as hands-on educational tools that reflect real-world construction practices using mass timber and steel hybrid systems. Available in a range of sizes from full-scale booths to compact models, each mockup clearly demonstrates structural components, material connections, and construction techniques. All mockups are fully customizable to fit the specific needs of your training program or field application, ensuring your team gains practical, jobsite-ready experience.

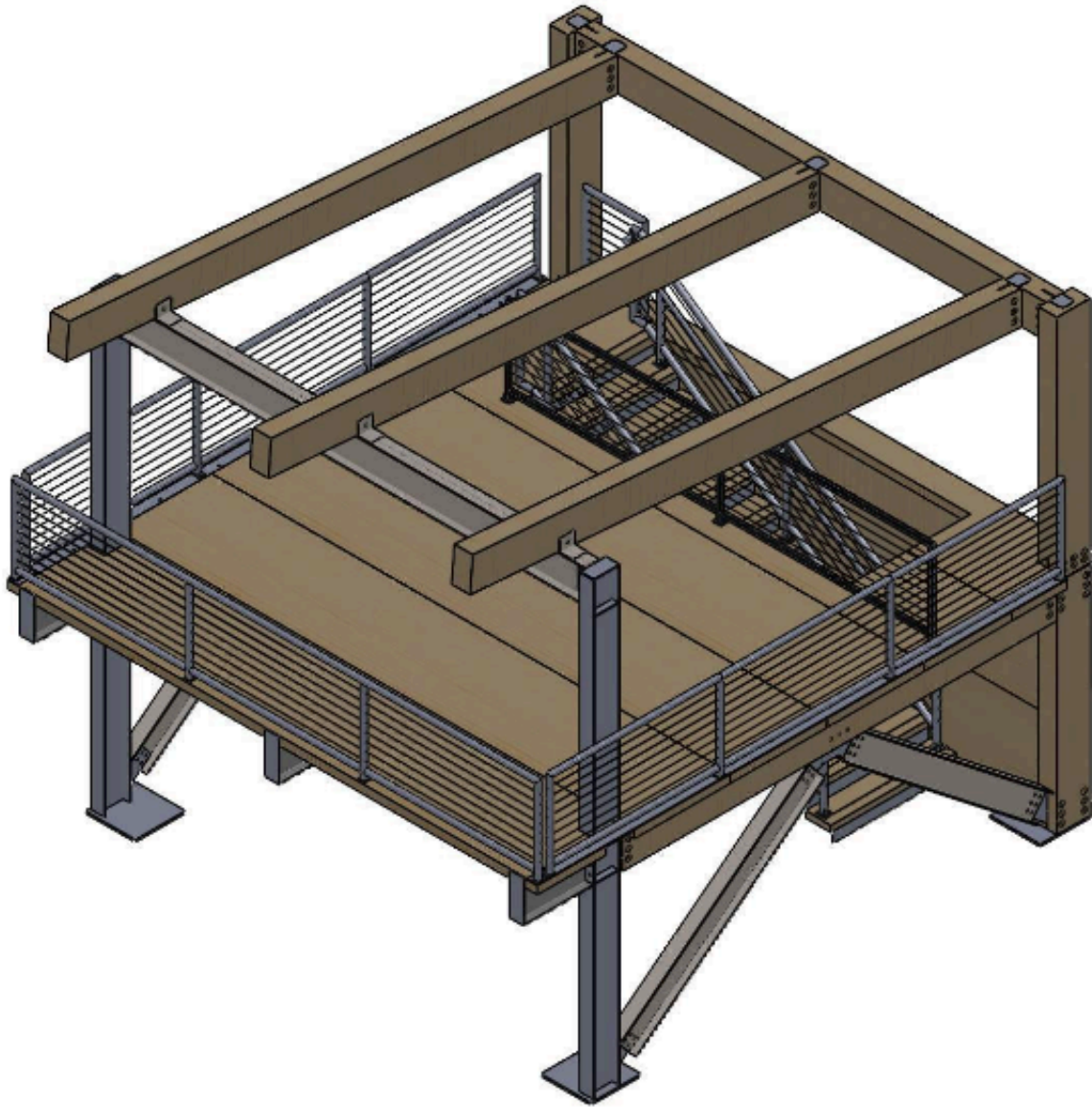

## 20X20 MTB MOCKUP

This full-scale 20'x20' booth showcases a highly detailed hybrid structure using both mass timber and steel. It includes steel columns and a 3-ply cross-laminated timber (CLT) shear wall, providing lateral stability. Glulam beams and CLT floor panels demonstrate key load-bearing systems used in modern timber construction. The hybrid stairs combine timber and steel, and the cable railing offers a clean, safe, and functional finishing touch. This booth is designed to be the most impressive and complete educational tool, offering real-world context for how hybrid systems are constructed and connected on a job site.

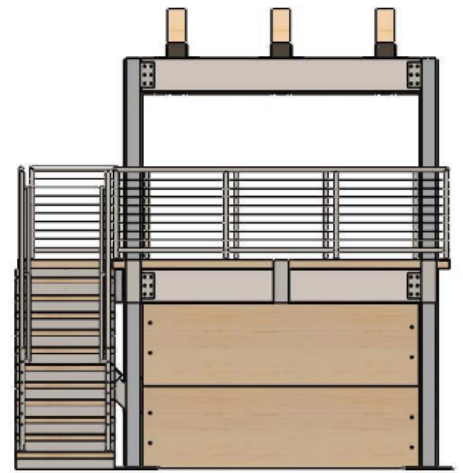
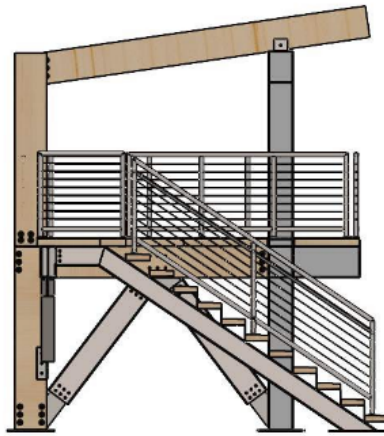
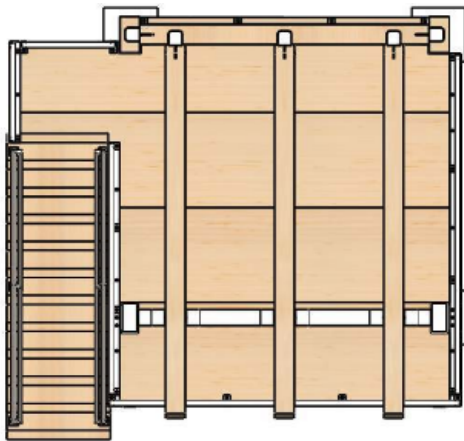
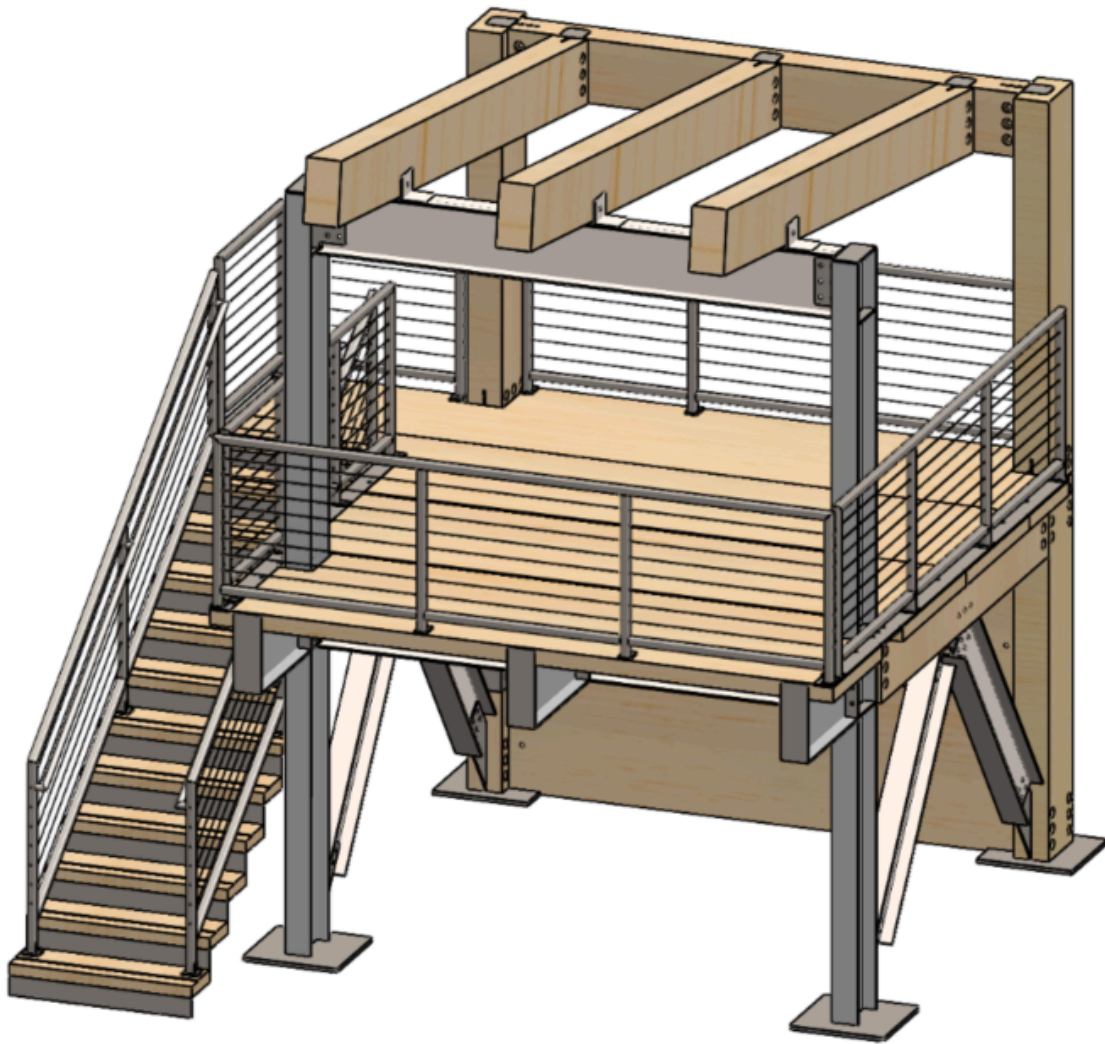

## 12X12 MTB MOCKUP

A scaled-down version of the 20'x20', this booth features glulam beams, CLT panels, and key steel components. It's ideal for teaching mass timber construction in smaller spaces without losing critical learning features.

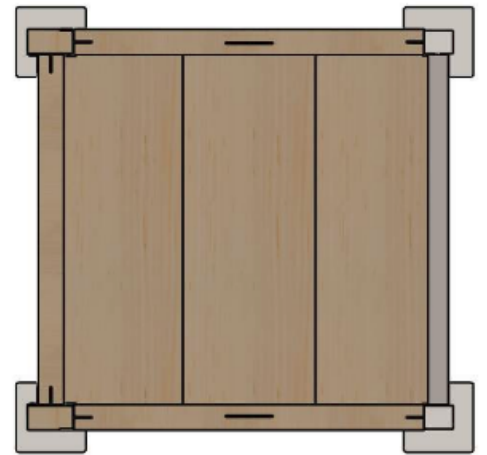
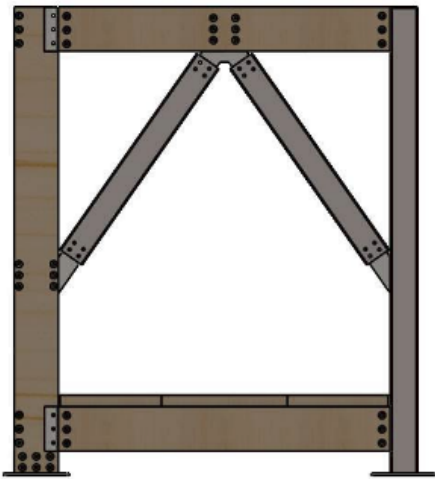
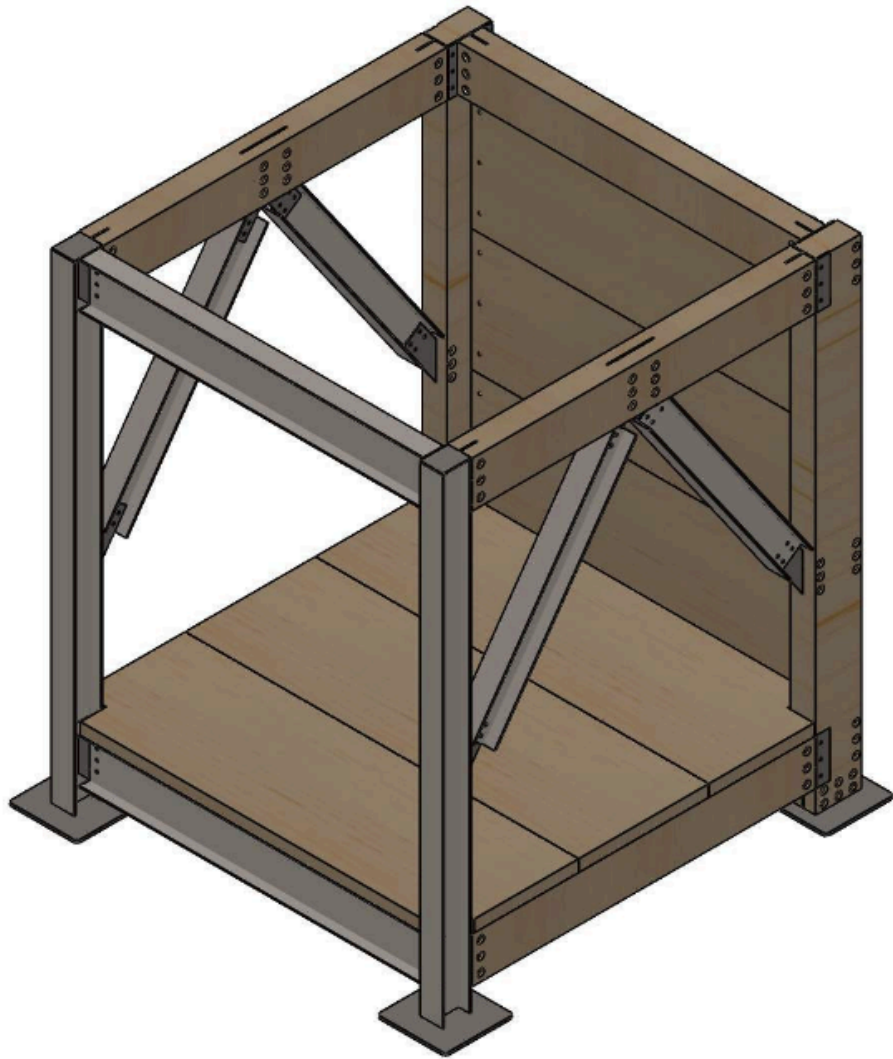

## 12X12 MTSS MOCKUP

This simplified structure uses glulam beams, CLT panels, and steel to teach core mass timber assembly techniques. It's perfect for field training and entry-level instruction.

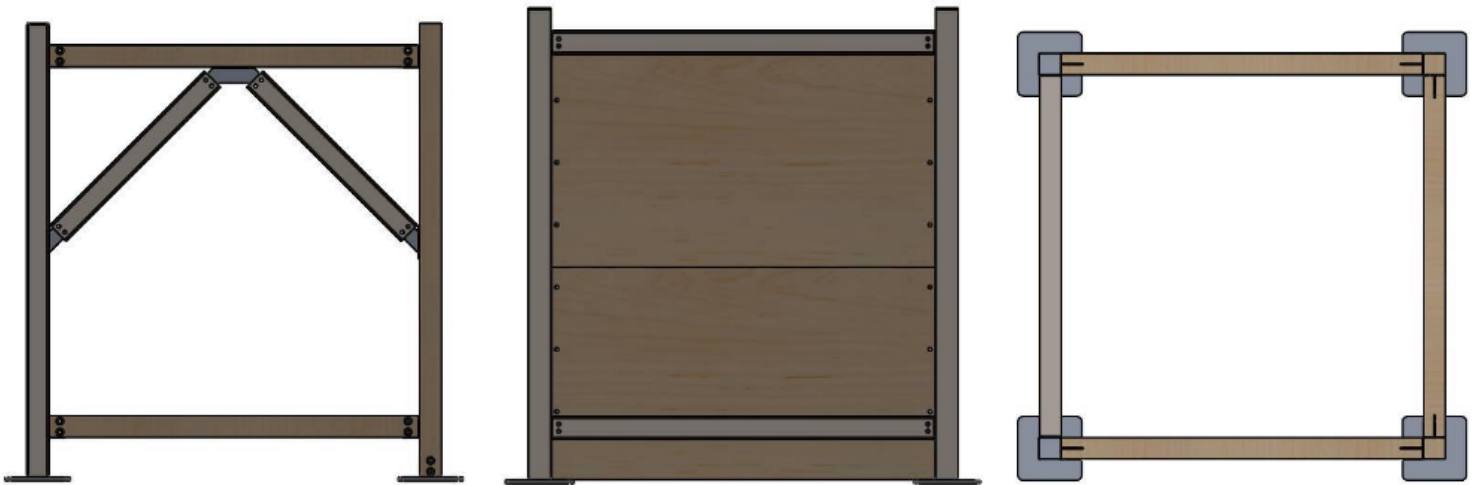
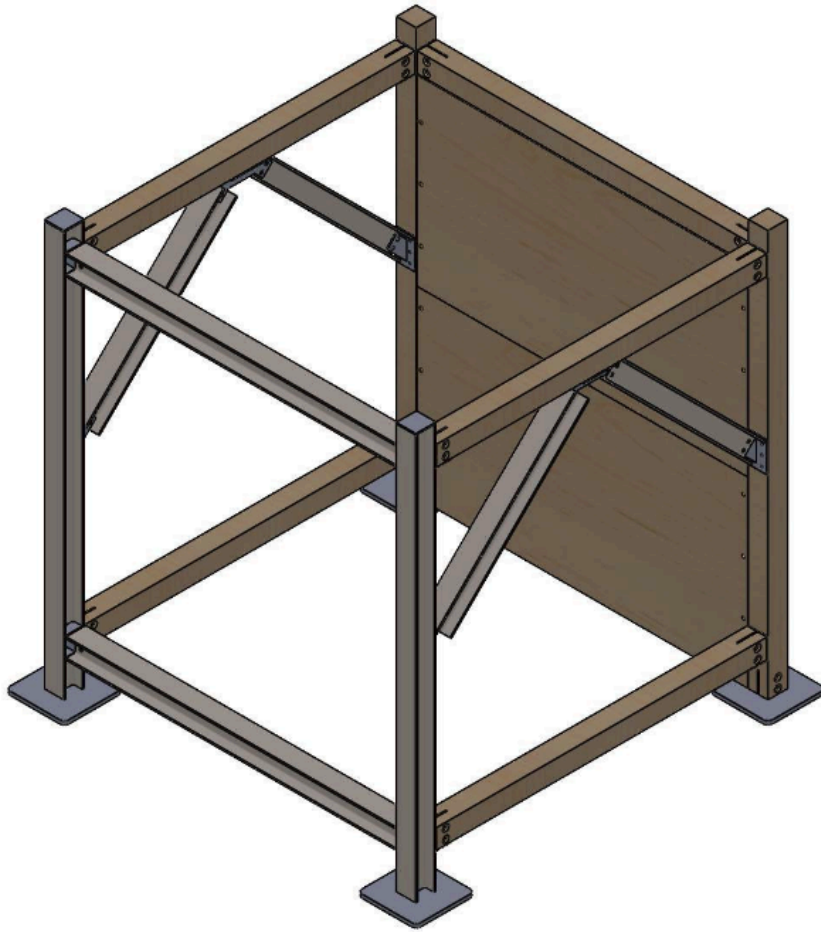

## 6X6 MTSS MOCKUP

Compact yet impactful, this mockup highlights key mass timber elements with glulam and CLT in a clear, accessible format. Ideal for on structural systems.

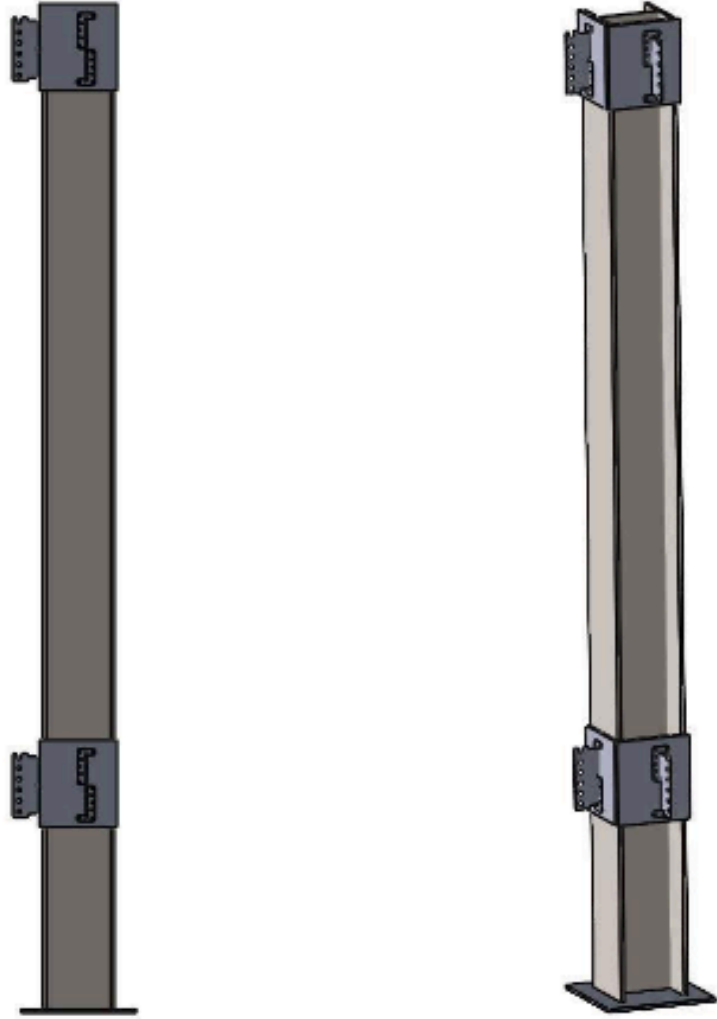

## STEEL REPLACEMENT COLUMNS (2 TOTAL)

### OPTION 1

Hot dip galvanize coating  
with engineering

### OPTION 2

Prime paint coating with  
engineering

### OPTION 3

Prime and paint only.  
Exclude Engineering

# FOUST

★ FAB & ERECTORS ★



**COBY FOUST**  
CEO/PRESIDENT

*coby@foustfab.com*  
509.684.3754  
1159 Orin Rice Rd  
Colville, WA 99114

**MIKE SITTON**  
Small Works Manager  
*mike@foustfab.com*  
509.684.3754 x 102

**NATE BELYEA**  
Estimator/Superintendent  
*nate@foustfab.com*  
509.684.3754 x 103

**MIREYA FITZLOFF**  
Sr Project Manager  
*mireya@foustfab.com*  
509.684.3754 x 105

**STEVE DAVIS**  
Lead Draftsman  
*steve@foustfab.com*  
509.684.3754 x 104

[www.foustfab.com](http://www.foustfab.com)